

A man in a dark jacket and black pants is riding a black electric bike with large, knobby tires on a city street. He is looking off to the side. In the background, the Arch of Triumph is visible, along with other vehicles and trees. The scene is set in a city with a historic monument.

Ringo

We are proud to present you
the Ringo, *the street cowboy*.

Ringo

- *Off-Road yet Urban*
- *Compact but generous*
- *Vintage yet modern*

Ringo is a stylish post-apocalyptic looking compact bike, made for the city and the road with an all terrain versatility.

This practical two-seater bike has a head-spinner look, that will let you be the eye-catcher of the road, while riding with someone on the back.

This bike combines a great look, a comfortable position, and the features of all the latest Rayvolt smart technology.







EIVA Drive
and Throttle
to improve
your rides



With all the
premium details
that makes a
Rayvolt bike

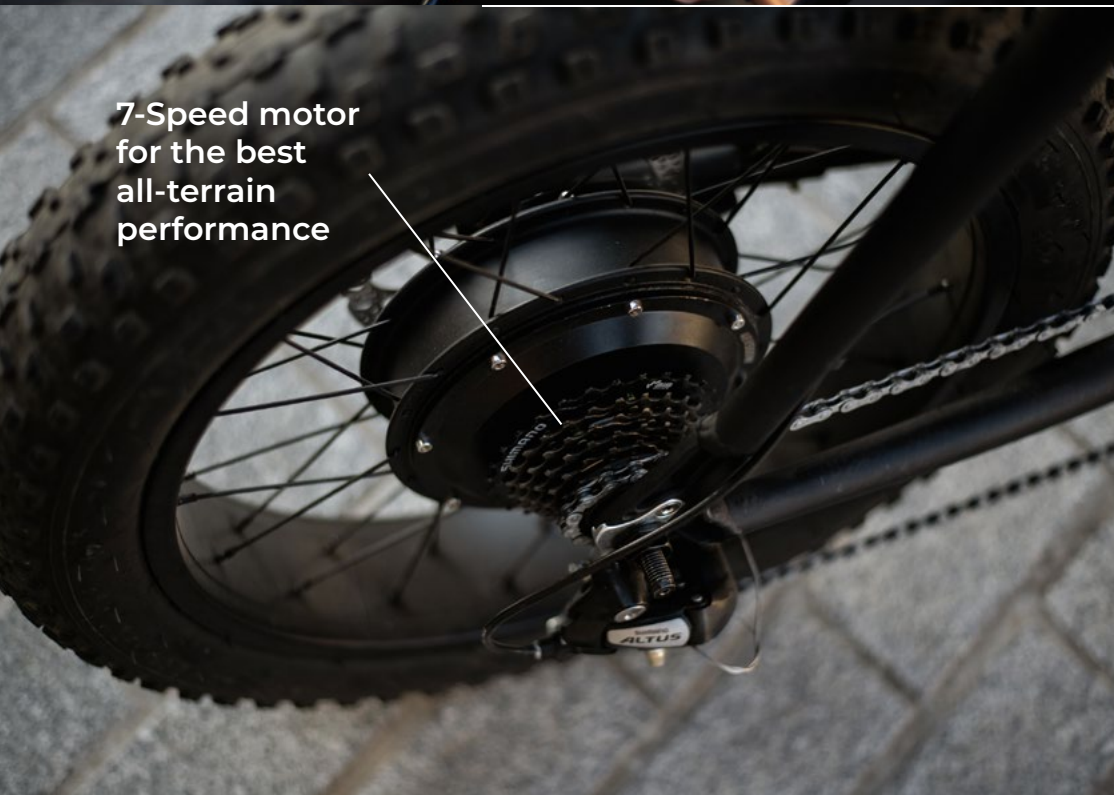

7-Speed motor
for the best
all-terrain
performance



Vintage Two-Seater
leather saddle for
the best riding
experience



RAW
SILVER
Ringo



CLOCKWORK
ORANGE
Ringo



SHADOW
BLACK
Ringo



Ringo Removable Battery

1.

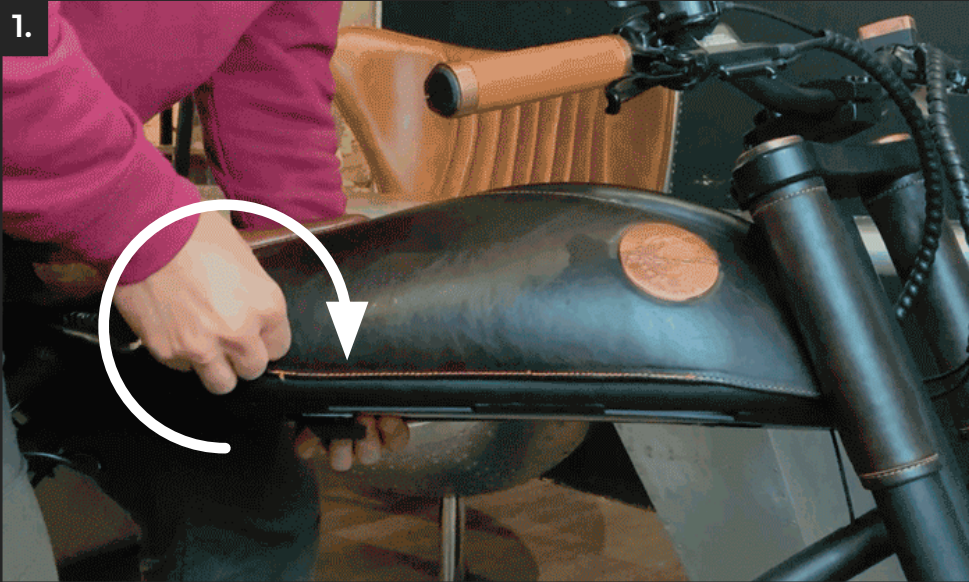

2.



3.



4. Place it again



Ringo Specifications

Weight:

32 kg - 33 kg

Frame:

Rayvolt Custom Al Hydroformed

Fork:

45mm Double Crown

Battery Cover:

Composite Shell Covered by Leather

Grips:

Rayvolt Custom Leather Grips

Saddle:

Rayvolt Two-Seater Custom Leather

Brakes:

Rayvolt Oil Disk Brakes with
E-Regenerative 10A-50A

Crankset:

Rayvolt Two pieces Crankset

Pedals:

Flat Rayvolt Pedals

Chain:

KMC Silver Chain

Rims:

Double wall 20" x 80 mm

Tires:

20" x 41/4"

Speed Control:

- PAS (Pedal Assist System)
- Shimano 7 speed
- Thumb Throttle*
- Torque Sensor (optional)

E-Drive System:

Rayvolt EIVA® Drive

Motor

250W Smart Hub 40 Nm

Battery

Life of 1000 cycles

- **Django Smart**
Removable 36V 10.5Ah
Range of 40km
Charge time of 2,5 hours
- **Django Smart +**
Removable 36V 13Ah
Range of 50km
Charge time of 3 hours
- **Django Smart ++**
Removable 36V 16.5 Ah
Range of 60km
Charge time of 4 hours

*Depending on your country legislation

Dimensions:

1687 x 980 x 700 mm

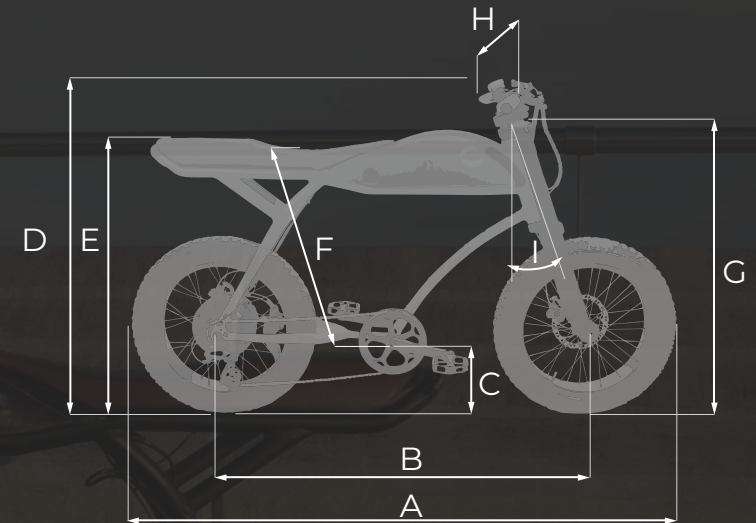

A	1687 mm
B	1100 mm
C	283 mm
D	980 mm
E	848 mm
F	648 mm
G	950 mm
H	700 mm
I	21°





RAYVOLT